

NOTES: UNLESS OTHERWISE SPECIFIED

1. CONSTRUCTION:

TERMINAL RING:

CONTACT: BRIGHT TIN PLATED ETP COPPER

INSULATOR: BLUE VINYL

STK PIN PLUG:

HOUSING: MOLDED NYLON AVAILABLE IN ALL TEN COLORS

FRAME: NICKEL PLATED BRASS

SPRING: SILVER PLATED BeCu OR PHOSPHOR BRONZE

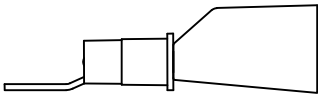
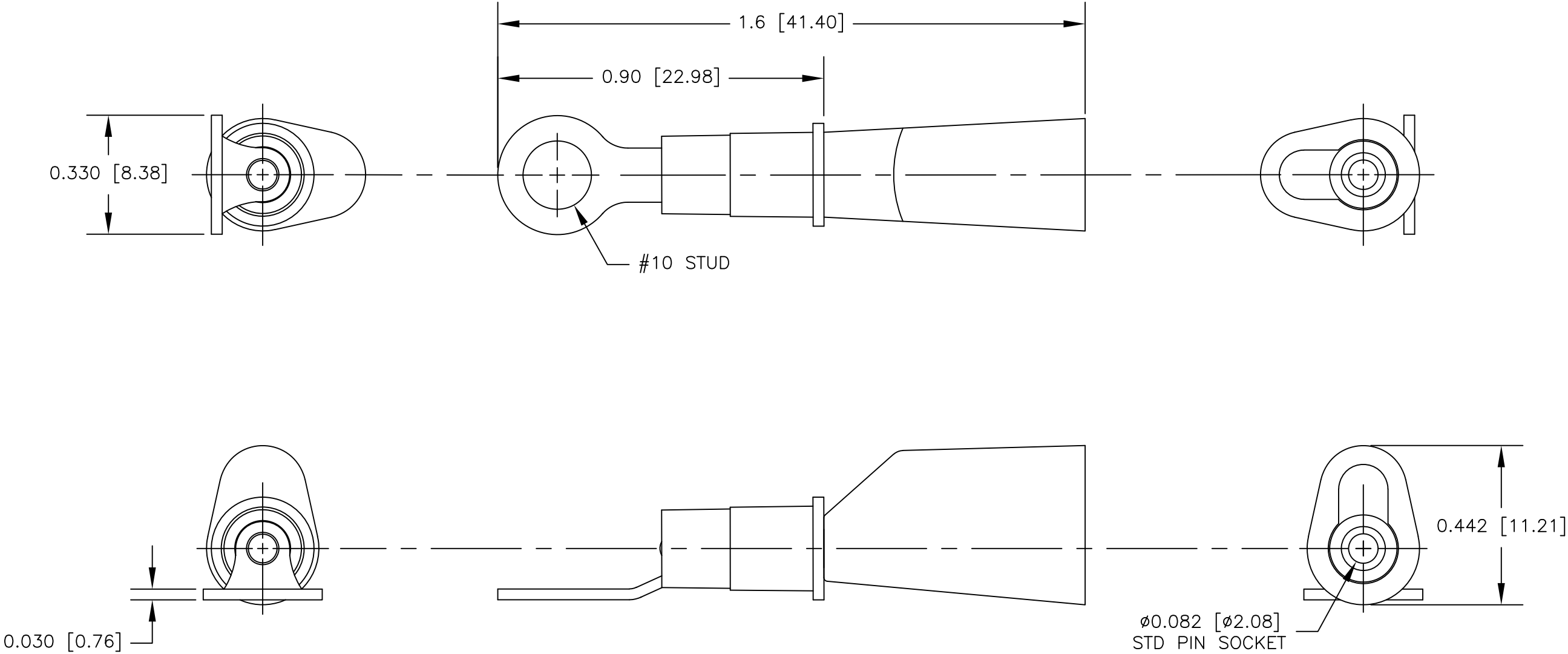

ACTUAL SIZE

UNLESS OTHERWISE SPECIFIED DIMENSIONS ARE IN INCHES TOLERANCES ARE: FRACTIONS DECIMALS ANGLES ± N/A .XX ± N/A ± N/A .XXX ± N/A	CONTRACT NO.		E-Z-HOOK® DIVISION OF TEKTEST INC. ARCADIA, CA 91006 U.S.A.			
	APPROVALS	DATE				
	DRAWN R.L.	9/19	#10 INSULATED TERMINAL RING TO STK STD PIN PLUG			
	APPROVED BY					
MATERIAL SEE NOTE			SIZE	CODE IDENT NO.	DRAWING NO.	REV.
FINISH SEE NOTE			B	08505	9496	
DO NOT SCALE DRAWING			SCALE	3:1		SHEET 1 OF 1