

NOTES: UNLESS OTHERWISE SPECIFIED

1. MATERIAL:
 HOUSING: NYLON. AVAILABLE IN TEN COLORS
 FRAME: SILVER PLATED BRASS
 CONTACT: SILVER PLATED BeCu
 NUT: NICKEL PLATED

4. BODY THREAD STRIPPING TORQUE:
 0.4 LB IN [4.5 KG CM]

5. PANEL THICKNESS:
 UP TO .437 [11.10]

6. PERFORMANCE:
 CURRENT: 10 AMPS
 BREAKDOWN VOLTAGE: 5700 VRMS MIN
 CONTACT RESISTANCE: 0.010 OHMS MAX
 CONTACT TO PANEL C: 2 Pf NOMINAL

REVISIONS			
LTR	DESCRIPTION	DATE	APPROVED

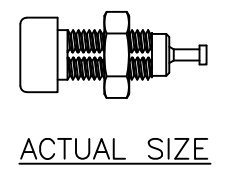
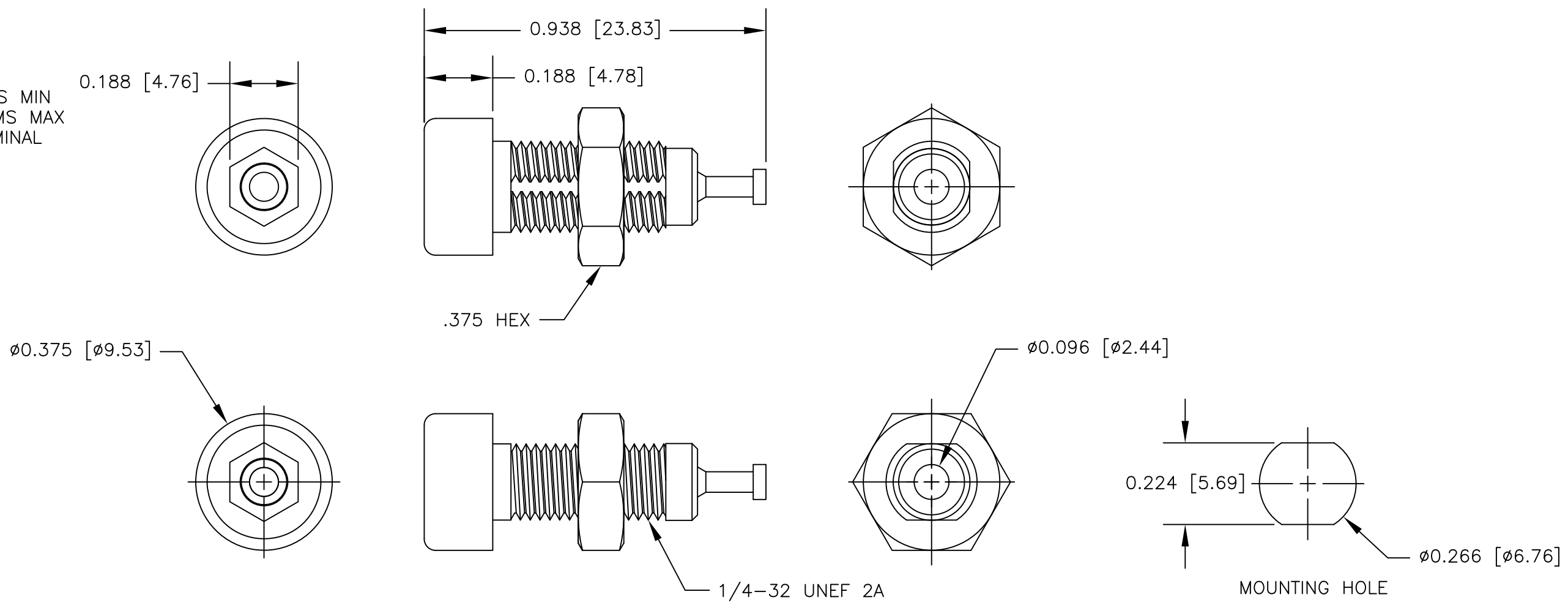

		UNLESS OTHERWISE SPECIFIED DIMENSIONS ARE IN INCHES TOLERANCES ARE: FRACTIONS DECIMALS ANGLES ± N/A .XX ± N/A ± N/A .XXX ± N/A	CONTRACT NO.		E-Z-HOOK DIVISION OF TEKTEST INC. ARCADIA, CA 91006 U.S.A.
			APPROVALS	DATE	
		MATERIAL SEE NOTE	DRAWN R.L.	4/18	DESCRIPTION STANDARD .080 TIP SOCKET
		FINISH SEE NOTE	APPROVED BY		SIZE B
NEXT ASSY	9218	USED ON			CODE IDENT NO. 08505
APPLICATION		DO NOT SCALE DRAWING			DRAWING NO. 9218
					SCALE 3:1
					REV.
					SHEET 1 OF 1