

NOTES: UNLESS OTHERWISE SPECIFIED

1. CONSTRUCTION:
HOUSING: MOLDED NYLON AVAILABLE IN ALL TEN COLORS
SOCKET & BAN FRAME: NICKEL PLATED BRASS.
CONTACT: NICKEL PLATED BeCu OR PHOSPHOR BRONZE.
END CAP: MACHINED DELRIN. WHITE
2. PERFORMANCE:
MAXIMUM CURRENT: 15 AMPS
MAXIMUM VOLTAGE: HANDHELD: 33VAC/60VDC
HANDS FREE: 3500 VRMS
MAXIMUM TEMPERATURE: 176°F (80°C)

LTR	REVISIONS		
	DESCRIPTION	DATE	APPROVED

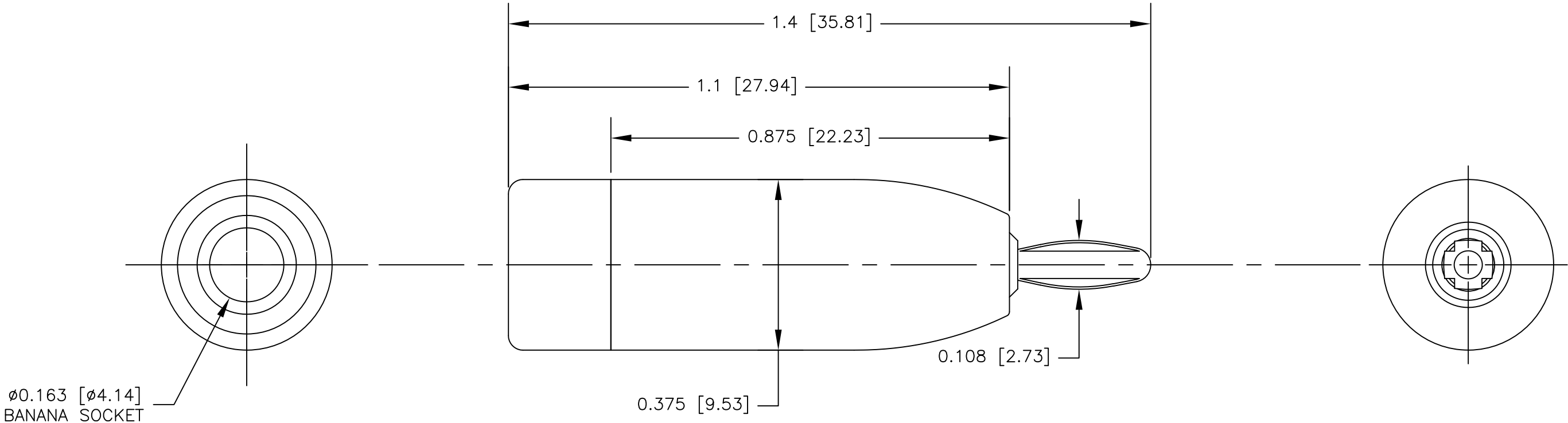

ACTUAL SIZE

		UNLESS OTHERWISE SPECIFIED DIMENSIONS ARE IN INCHES TOLERANCES ARE: FRACTIONS DECIMALS ANGLES ± N/A .XX ± N/A ± N/A .XXX ± N/A	CONTRACT NO.		E-Z-HOOK DIVISION OF TEKTEST INC. ARCADIA, CA 91006 U.S.A.			
			APPROVALS	DATE	DESCRIPTION MINI BAN PLUG TO STD BAN SKT			
			DRAWN R.L.	10/19				
		MATERIAL SEE NOTE	APPROVED BY		SIZE	CODE IDENT NO.	DRAWING NO.	REV.
		FINISH SEE NOTE			B	08505	8023	
NEXT ASSY	USED ON				SCALE	4:1		
APPLICATION		DO NOT SCALE DRAWING			SHEET 1 OF 1			