

NOTES: UNLESS OTHERWISE SPECIFIED

1. CONSTRUCTION:

HOUSING: NYLON. AVAILABLE IN ALL TEN COLORS.

FRAME: NICKEL PLATED BRASS.

CONTACT: NICKEL PLATED BeCu OR PHOSPHOR BRONZE.

HARDWARE: STAINLESS STEEL NUT. BRASS EYELET.

COPPER, TIN PLATED. TERMINAL RING.

ZINC PLATED STEEL LOCKWASHER.

2. PERFORMANCE:

MAXIMUM CURRENT: 15 AMPS

MAXIMUM VOLTAGE: <33V AC < 70V DC

MAXIMUM TEMPERATURE: 200°F (93°C)

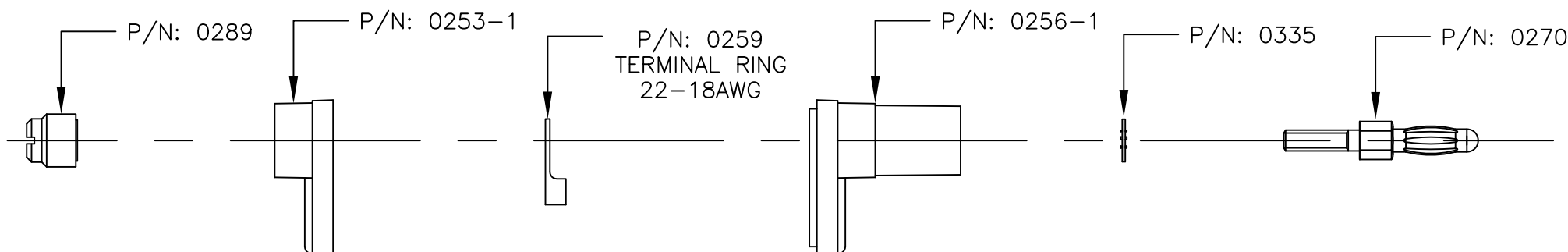
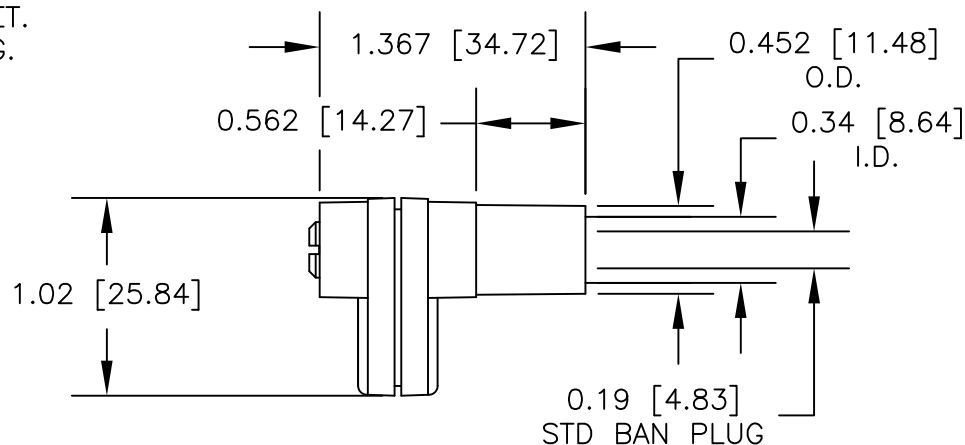

		UNLESS OTHERWISE SPECIFIED DIMENSIONS ARE IN INCHES TOLERANCES ARE: FRACTIONS DECIMALS ANGLES ± .XX ± ± .XXX ±	CONTRACT NO.		E-Z-HOOK ® DIVISION OF TEKTEST INC. ARCADIA, CA 91006 U.S.A.				
			APPROVALS	DATE					
		MATERIAL SEE NOTE.	DRAWN	R.L.	2/17	DESCRIPTION SHROUDED R/A STD BANANA PLUG			
			APPROVED BY						
		FINISH SEE NOTE.				SIZE	CODE IDENT NO.	DRAWING NO.	REV.
NEXT ASSY	USED ON					A	08505	9301	
APPLICATION		DO NOT SCALE DRAWING			SCALE		1:1	SHEET 1 OF 1	