

NOTES: UNLESS OTHERWISE SPECIFIED

1. CONSTRUCTION:
 HOUSING: MOLDED ACETAL. AVAILABLE IN BLK & RED
 CONTACT: NICKEL PLATED BRASS

2. PERFORMANCE:
 MAXIMUM CURRENT: 10 AMPS
 MAXIMUM VOLTAGE: 3500 VRMS
 MAXIMUM TEMPERATURE: 200°F (93°C)

LTR	DESCRIPTION	REVISIONS	
		DATE	APPROVED

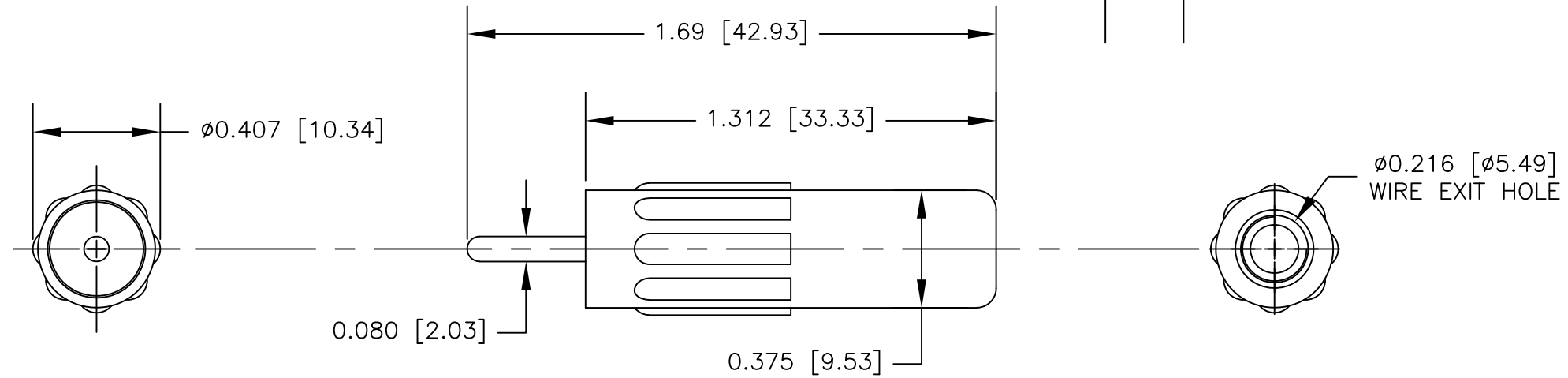

ASSEMBLY INSTRUCTIONS

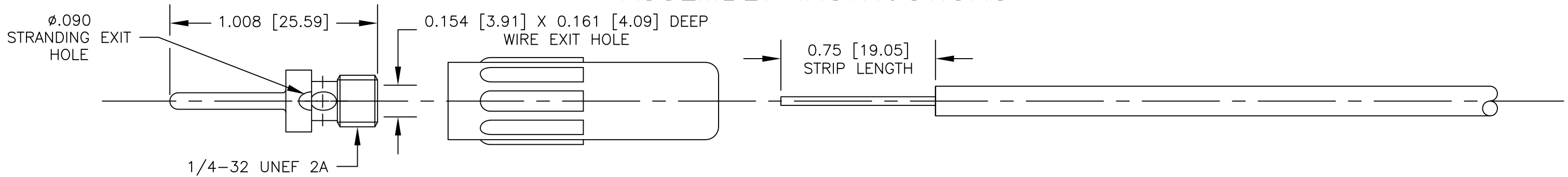

WRAP THE STRANDING UNDERNEATH THE THREADED SECTION OF THE BANANA PLUG IN A CLOCKWISE DIRECTION.

 NOTE: PLACING THE STRANDING ABOVE THE THREADED SECTION WILL CAUSE THE STRANDING TO BREAK OFF.

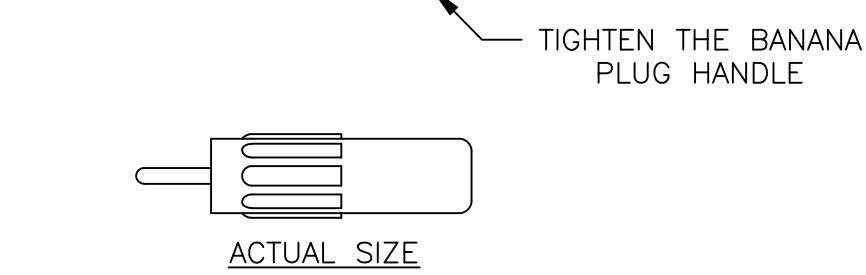
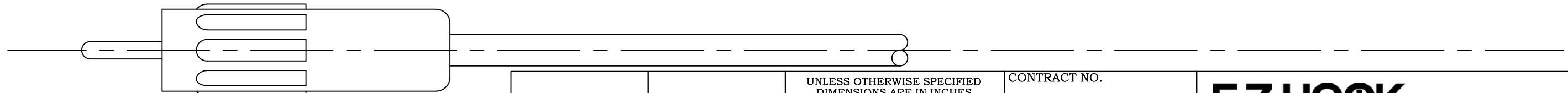
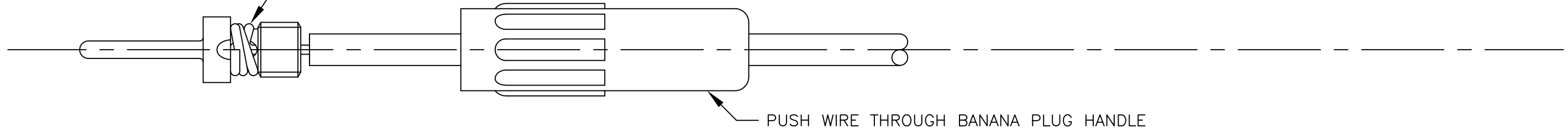

UNLESS OTHERWISE SPECIFIED DIMENSIONS ARE IN INCHES TOLERANCES ARE: FRACTIONS DECIMALS ANGLES ± N/A .XX ± N/A ± N/A .XXX ± N/A		CONTRACT NO.		E-Z-HOOK DIVISION OF TEKTEST INC. ARCADIA, CA 91006 U.S.A.
MATERIAL SEE NOTE		APPROVALS DRAWN R.L.	DATE 7/17	
FINISH SEE NOTE		APPROVED BY		DESCRIPTION STANDARD PIN PLUG W/HEAVY DUTY HANDLE
NEXT ASSY	USED ON	SCALE 2:1		SIZE B
APPLICATION		DO NOT SCALE DRAWING		CODE IDENT NO. 08505
				DRAWING NO. 9250
				REV.
				SHEET 1 OF 1