

NOTES: UNLESS OTHERWISE SPECIFIED

1. CONSTRUCTION:  
 HOUSING: MOLDED NYLON AVAILABLE IN ALL TEN COLORS  
 FRAME: NICKEL PLATED BRASS.  
 CONTACT: NICKEL PLATED BeCu OR PHOSPHOR BRONZE.
2. PERFORMANCE:  
 MAXIMUM CURRENT: 10 AMPS  
 MAXIMUM VOLTAGE: 3500 VRMS  
 MAXIMUM TEMPERATURE: 200°F (93°C)

LTR	DESCRIPTION	REVISIONS	
		DATE	APPROVED

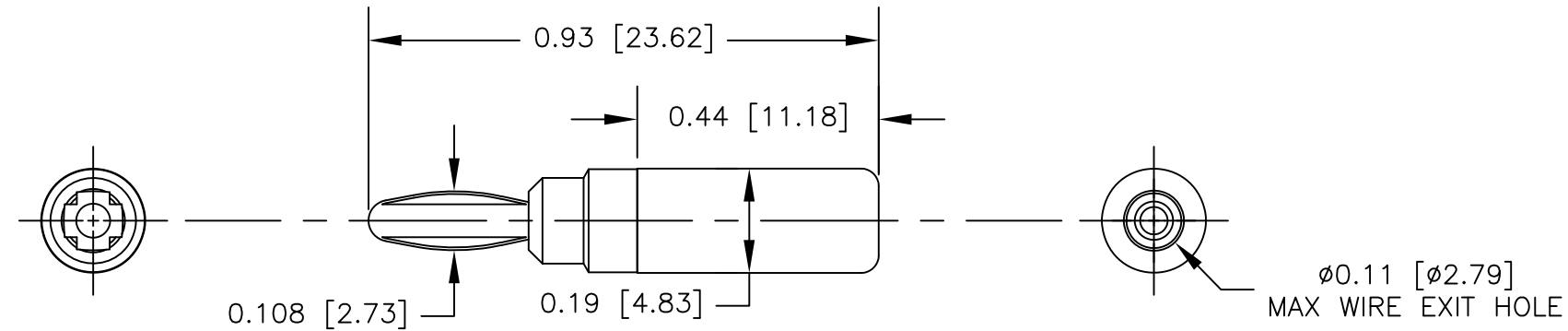

### ASSEMBLY INSTRUCTIONS

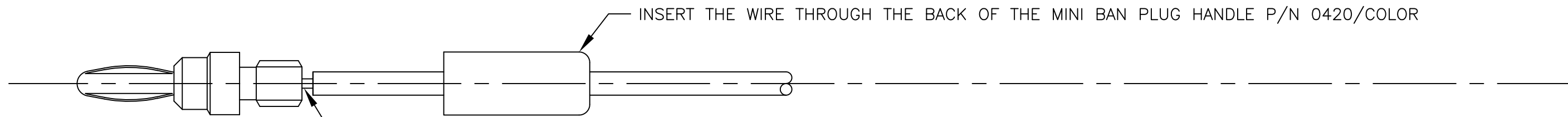
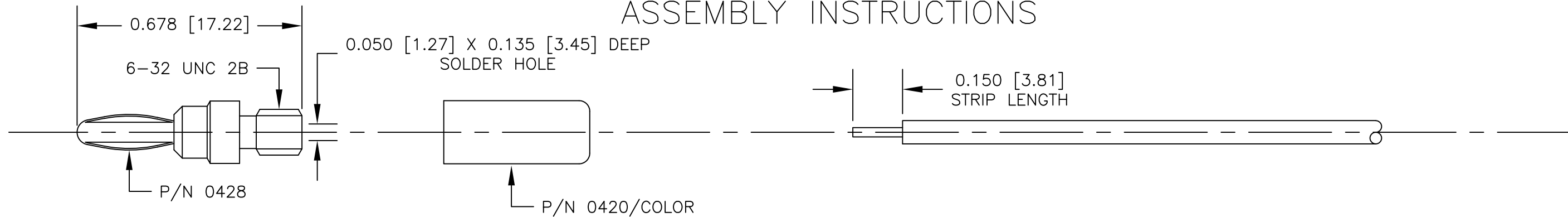

MELT SOME SOLDER IN THE MINI BAN PLUG P/N 0428 SOLDER HOLE. WHILE THE SOLDER IS HOT QUICKLY INSERT THE STRANDING INTO THE SOLDER HOLE. REMOVE THE MINI BAN PLUG FROM THE HEAT. HOLD THE WIRE IN PLACE WHILE THE SOLDER HARDENS.

\*\*\*\*\*  
 TRY TO AVOID GETTING SOLDER ON THE THREADS. THIS WILL MAKE IT DIFFICULT TO SCREW ON THE MINI BAN PLUG HANDLE P/N 0420

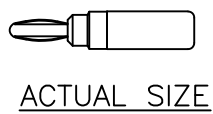
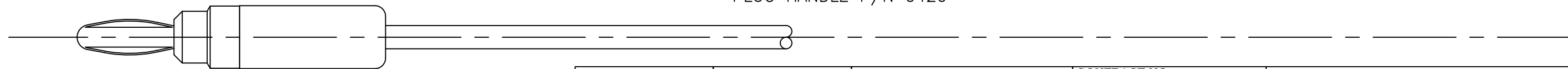

SCREW ON MINI BAN PLUG HANDLE P/N 0420/COLOR

UNLESS OTHERWISE SPECIFIED DIMENSIONS ARE IN INCHES TOLERANCES ARE: FRACTIONS DECIMALS ANGLES ± N/A .XX ± N/A ± N/A .XXX ± N/A		CONTRACT NO.		<b>E-Z-HOOK</b> DIVISION OF TEKTEST INC. ARCADIA, CA 91006 U.S.A.	
MATERIAL SEE NOTE		APPROVALS	DATE		
FINISH SEE NOTE		DRAWN R.L.	4/18	DESCRIPTION MINI BANANA PLUG	
NEXT ASSY		APPROVED BY		SIZE	REV.
USED ON				B	
APPLICATION		DO NOT SCALE DRAWING		CODE IDENT NO.	DRAWING NO.
				08505	9213
				SCALE	
				3:1	SHEET 1 OF 1