

NOTES: UNLESS OTHERWISE SPECIFIED

- 1. CONSTRUCTION:
HOUSING: VINYL PLASTIC, RED
TERMINAL: TIN PLATED COPPER
- 2. PERFORMANCE:
MAXIMUM VOLTAGE: 600V
MAXIMUM TEMPERATURE: 220°F (104°C)

LTR	DESCRIPTION	REVISIONS	
		DATE	APPROVED

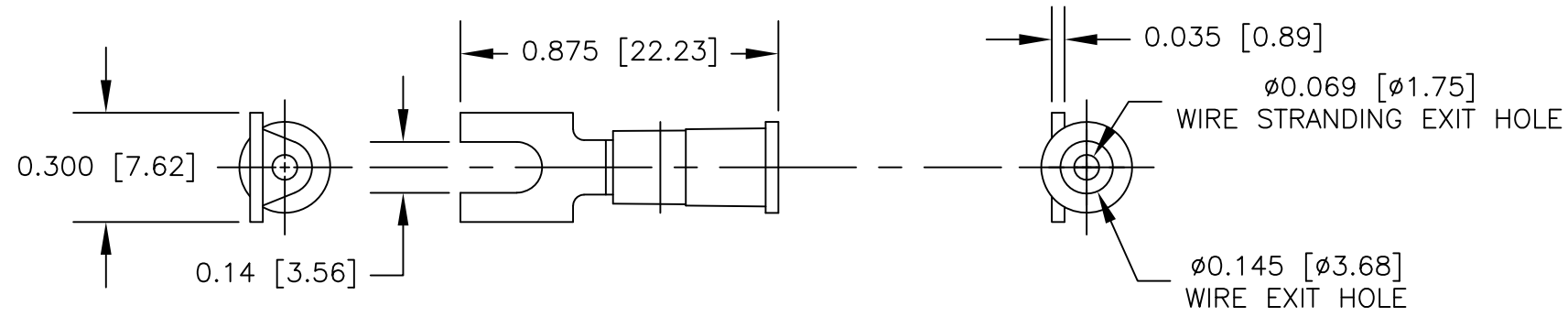

ASSEMBLY INSTRUCTIONS

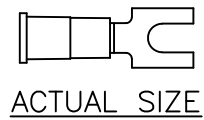
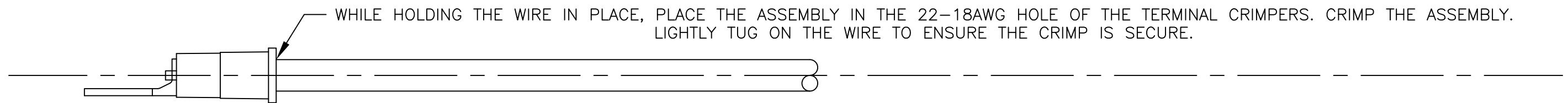
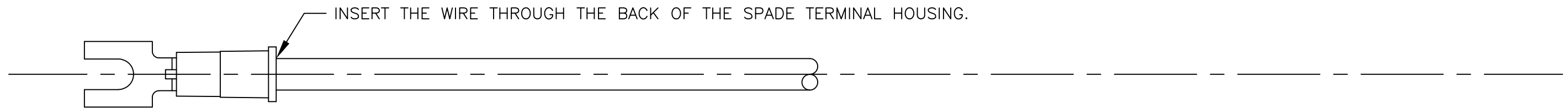
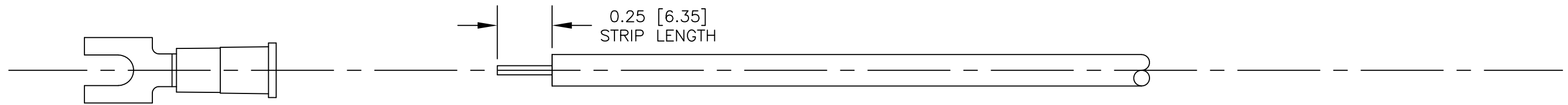

		UNLESS OTHERWISE SPECIFIED DIMENSIONS ARE IN INCHES TOLERANCES ARE: FRACTIONS DECIMALS ANGLES ± N/A .XX ± N/A ± N/A .XXX ± N/A	CONTRACT NO.		E-Z-HOOK DIVISION OF TEKTEST INC. ARCADIA, CA 91006 U.S.A.
			APPROVALS	DATE	
		MATERIAL SEE NOTE	DRAWN S.B.W.	4/92	DESCRIPTION 0.14 [3.56] SPADE TERMINAL
		FINISH SEE NOTE	APPROVED BY		SIZE CODE IDENT NO. DRAWING NO. REV.
NEXT ASSY	USED ON				B 08505 9209
APPLICATION		DO NOT SCALE DRAWING			SCALE 2:1 SHEET 1 OF 1