

NOTES: UNLESS OTHERWISE SPECIFIED

1. CONSTRUCTION:

- SLIDE: MOLDED NYLON. AVAILABLE IN TEN COLORS.
- HANDLE: MOLDED ACETAL. AVAILABLE IN BLACK & RED
- SPADE LUG: NICKEL PLATED BRASS OR BRIGHT DIP NICKEL SILVER
- CONTACT BLADE: NICKEL SILVER
- SPRING: STAINLESS STEEL

LTR	DESCRIPTION	REVISIONS	
		DATE	APPROVED
A	HANDLE REDESIGN.	12/16	R.L.

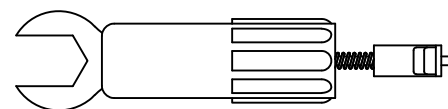
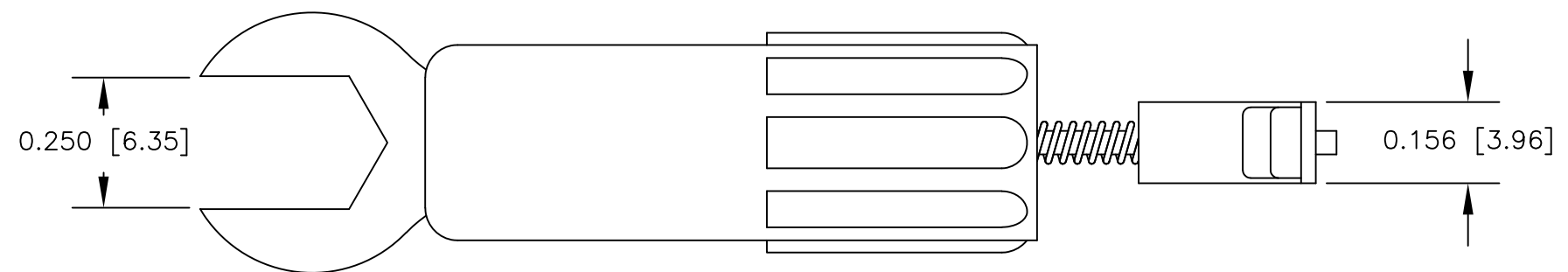
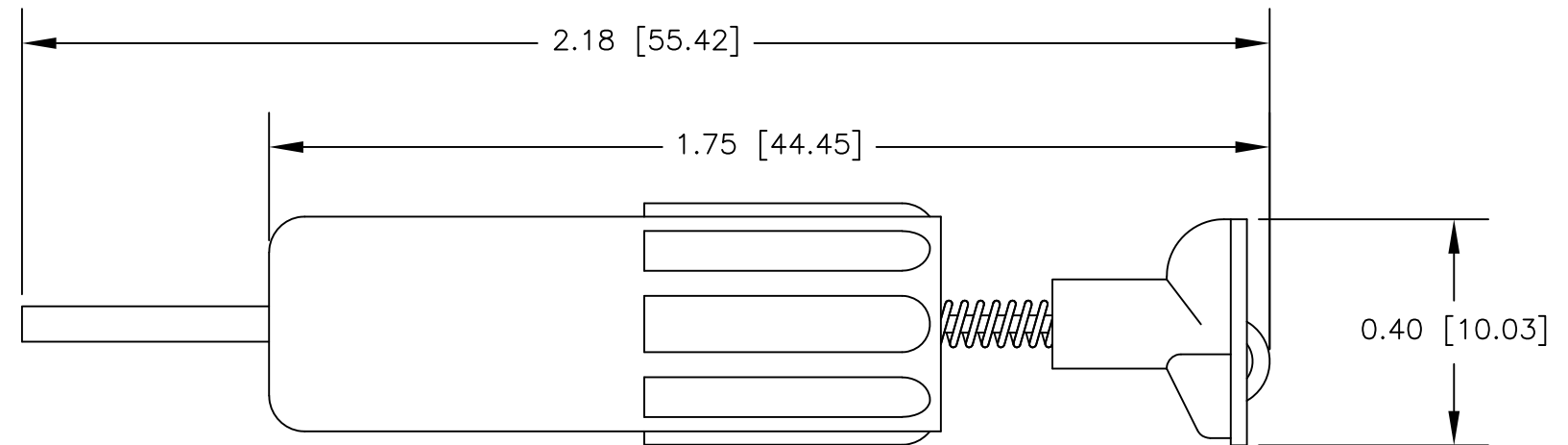
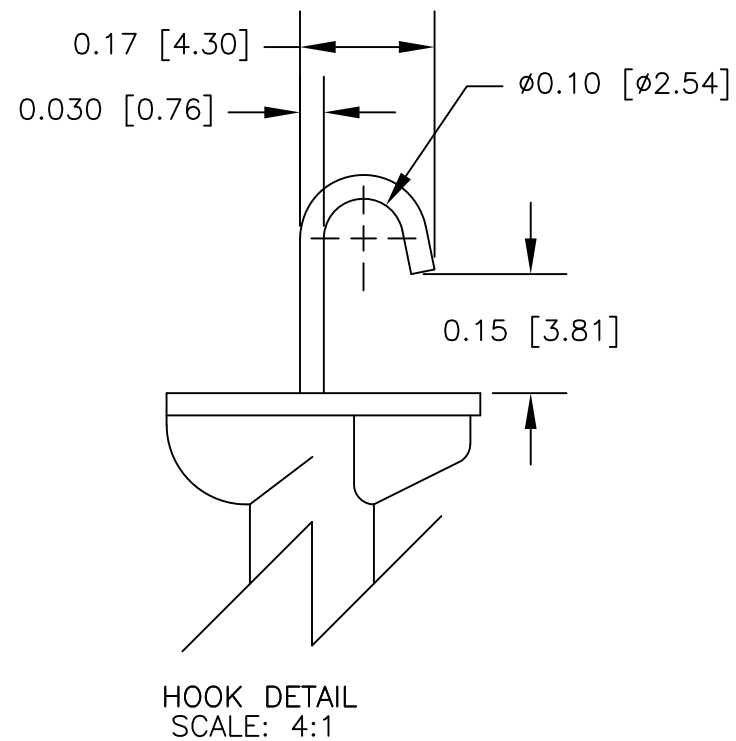

ACTUAL SIZE

		UNLESS OTHERWISE SPECIFIED DIMENSIONS ARE IN INCHES TOLERANCES ARE: FRACTIONS DECIMALS ANGLES ± .XX ± ± .XXX ±	CONTRACT NO.		<b>E-Z-HOOK</b> DIVISION OF TEKTEST INC. ARCADIA, CA 91006 U.S.A.
			APPROVALS	DATE	
		MATERIAL SEE NOTE.	DRAWN R.L.	8/18	DESCRIPTION TERMINAL CLIP ON .250" SPADE LUG
		FINISH SEE NOTE.	APPROVED BY		
NEXT ASSY	USED ON				SIZE <b>B</b>
APPLICATION		DO NOT SCALE DRAWING			CODE IDENT NO. <b>08505</b>
					DRAWING NO. <b>8104</b>
					REV. <b>A</b>
					SCALE 3:1
					SHEET 1 OF 1