

NOTES: UNLESS OTHERWISE SPECIFIED

1. MATERIAL:  
 INSULATION: POLYAMIDE/POLYPROPYLENE. AVAILABLE  
 IN BLK, RED  
 CONTACT: NICKEL PLATED BRASS

2. PERFORMANCE  
 MAXIMUM CURRENT: 1 AMPS  
 MAXIMUM VOLTAGE: 33 VAC/70 VDC  
 MAXIMUM TEMPERATURE: 176°F (80°C)

LTR	REVISIONS		DATE	APPROVED
	DESCRIPTION			

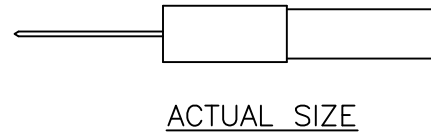
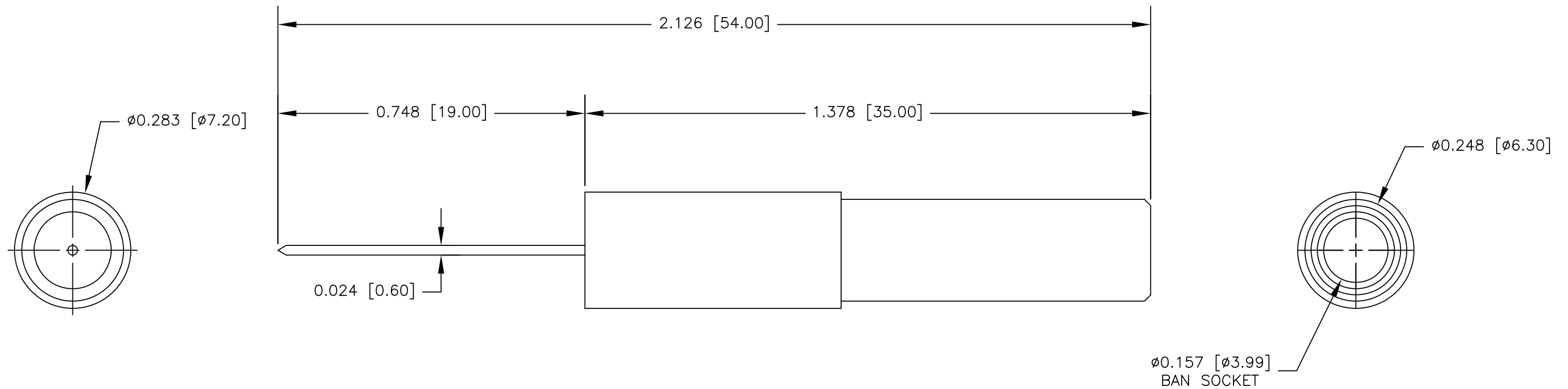

		UNLESS OTHERWISE SPECIFIED DIMENSIONS ARE IN INCHES TOLERANCES ARE: FRACTIONS DECIMALS ANGLES ± N/A .XX ± N/A ± N/A .XXX ± N/A	CONTRACT NO.		<b>E-Z-HOOK</b> DIVISION OF TEKTEST INC. ARCADIA, CA 91006 U.S.A.
			APPROVALS	DATE	
		MATERIAL SEE NOTES	DRAWN R.L.	9/18	DESCRIPTION Ø.024 NEEDLE TO BAN SKT ADAPTER, BACKPROBE DEVICE
		FINISH SEE NOTES	APPROVED BY		
NEXT ASSY	USED ON				SIZE <b>B</b>
APPLICATION		DO NOT SCALE DRAWING			CODE IDENT NO. <b>08505</b>
					DRAWING NO. <b>8064</b>
					SCALE 4:1
					REV. SHEET 1 OF 1