

NOTES: UNLESS OTHERWISE SPECIFIED

1. P/N: 8930
FRAME: NICKEL PLATED BRASS
CONTACT: GOLD PLATED BRASS.
DIELECTRIC: PTFE
2. P/N: 049/0
HOUSING: BLACK DELRIN
3. P/N: 0443
FRAME: NICKEL PLATED BRASS
CONTACT: NICKEL PLATED BeCu OR PHOSPHOR BRONZE
4. PERFORMANCE:
MAX VOLTAGE:
HANDS HELD TESTING: <33V AC<70 VDC
HANDS FREE TESTING: 500 V RMS
MAX TEMPERATURE:
248° F (120° C)

LTR	REVISIONS		
	DESCRIPTION	DATE	APPROVED

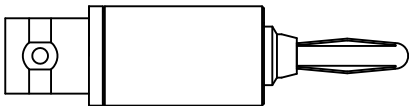
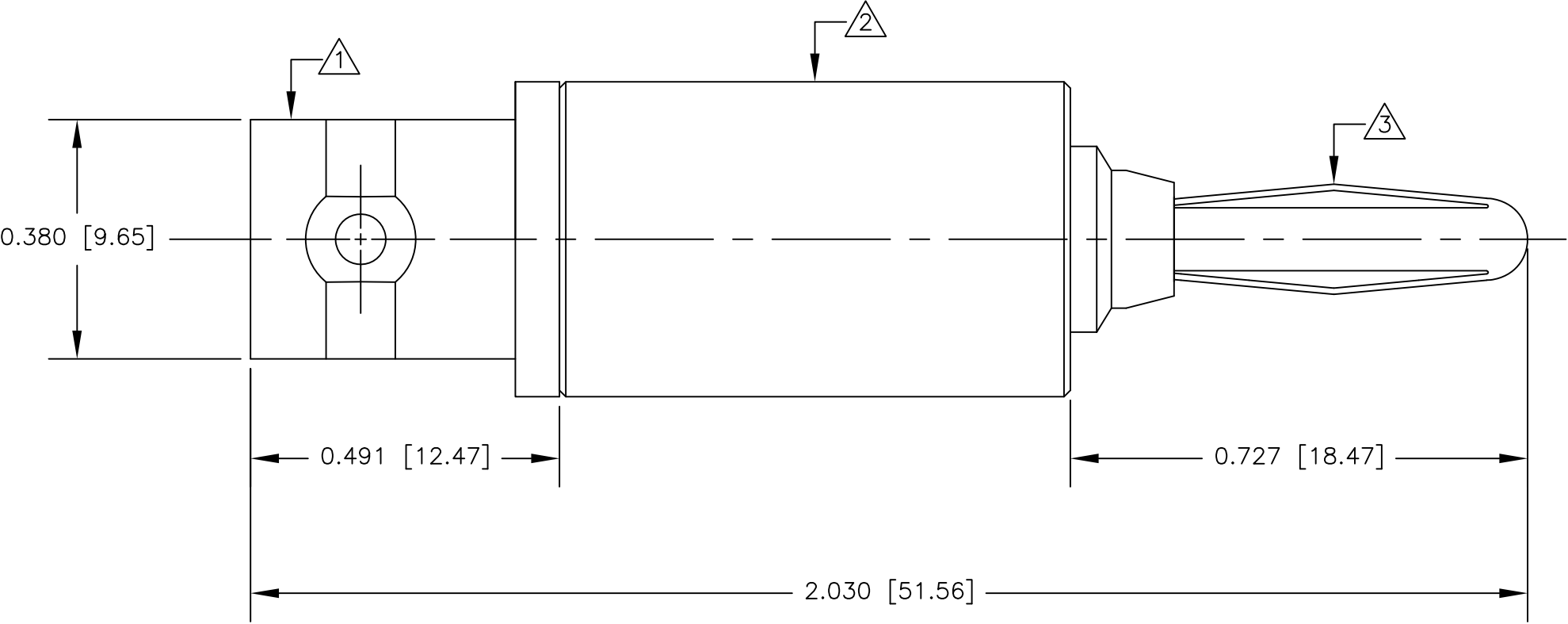

ACTUAL SIZE

		UNLESS OTHERWISE SPECIFIED DIMENSIONS ARE IN INCHES TOLERANCES ARE: FRACTIONS DECIMALS ANGLES ± N/A .XX ± N/A ± N/A .XXX ± N/A	CONTRACT NO.		<div>E-Z-HOOK®</div> <div>DIVISION OF TEKTEST INC. ARCADIA, CA 91006 U.S.A.</div>			
			APPROVALS	DATE				
			DRAWN R.L.	12/18				
		MATERIAL SEE NOTES	APPROVED BY		DESCRIPTION BNC FEMALE TO STD BAN PLUG ADAPTER			
		FINISH SEE NOTES			SIZE	CODE IDENT NO.	DRAWING NO.	REV.
NEXT ASSY	USED ON				B	08505	8013	
APPLICATION		DO NOT SCALE DRAWING			SCALE	4:1	SHEET 1 OF 1	